

General Fastener Specification

Head Styles

Drive Types

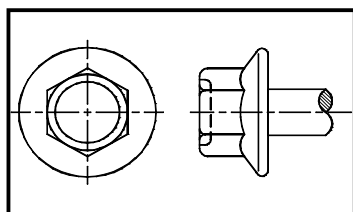

Hex-Flange

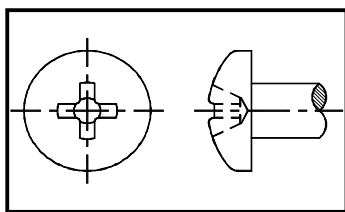

Pan

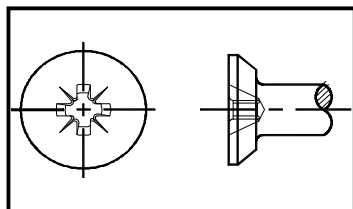

Counter-Sunk

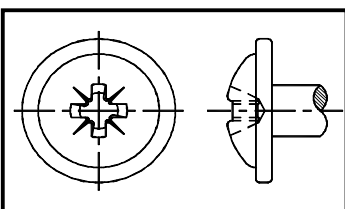

Pan-Flange

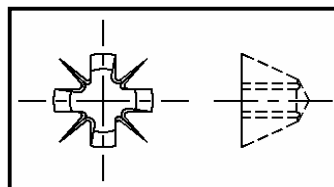

Pozi Recess

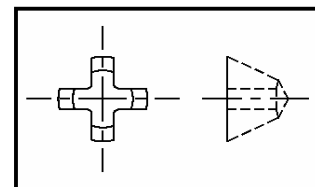

Phillips Recess

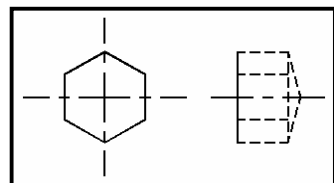

Allen Recess

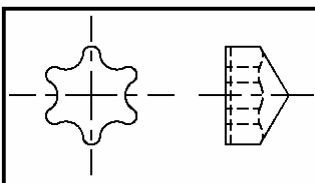

6-Lobe Recess

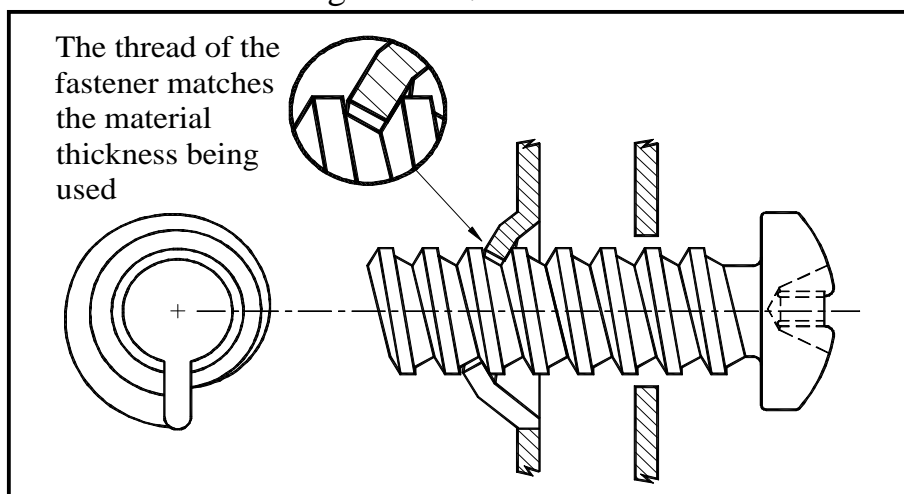

Material Thickness			Thread Diameters Available									
Imperial	UK Wire	Metric	Ø2.5	Ø3.0	Ø3.5	Ø4.0	Ø5.0	Ø6.0	Ø8.0	Ø10.0	Ø12.0	Ø14.0
0.020/0.024	25	0.5/0.6	X	X	X	X	X	X				
0.028/0.032	22/21	0.7/0.8		X	X	X	X	X	X			
0.036/0.040	20/19	0.9/1.0				X	X	X	X	X		
0.043/0.047	18	1.1/1.2					X	X	X	X	X	
0.051/0.055	17	1.3/1.4						X	X	X	X	
0.059/0.063	16	1.5/1.6						X	X	X	X	X
0.067/0.071	15	1.7/1.8							X	X	X	X
0.074/0.078	14	1.9/2.0							X	X	X	X
0.093/0.099	13	2.4/2.5								X	X	X

	Thread Diameters									
	Ø2.5	Ø3.0	Ø3.5	Ø4.0	Ø5.0	Ø6.0	Ø8.0	Ø10.0	Ø12.0	Ø14.0
Minimum Thread Length's	4.5	5	6	7	8.5	10	15	20	25	25

Above Dimension's for Fastener Length's and Diameters are in Millimetres
The tables above give a guide to the options available with High Torque Fastener Systems.